

NGFA's 120th
Annual Convention
The Difference Makers



Welcome to the
Hotel del Coronado



Follow convention news  #NGFAConv16

The Difference Makers

Welcome from the NGFA Chairman



**NGFA Chairman
Gary Beachner**

President and Chief
Executive Officer,
Beachner Grain Inc.
Parsons, Kan.

Welcome to San Diego and the incomparable Hotel del Coronado!

It's a pleasure to welcome more than 700 members and guests to the National Grain and Feed Association's (NGFA) 120th annual convention.

I especially want to welcome all new members and first-time attendees. It's great to have all of you here, and I encourage you to participate actively!

A special welcome, too, to new NGFA committee apprentices who are attending their first convention! It's our third year of extending this welcome, and it's been wonderful to see the program grow and to work with these talented newer representatives from NGFA-member companies as they get involved in NGFA's committee system.

We're also pleased to welcome members and executive staff from the North American Export Grain Association (NAEGA), who are joining us for their annual meeting. The NGFA and NAEGA are co-located in Washington. The mutual collaboration and synergy that this arrangement makes possible helps our industry effectively address a broader range of major policy issues than we could otherwise, helping us pursue the industry's global strategic objectives. It's a model for other trade associations on how to best serve their industry sectors.

This year's convention theme is "The Difference Makers." Today's world poses many challenges: geopolitical, economic, logistical, regulatory, and more. These are challenges that require each of us individually, and our premier national trade association, to redouble our efforts to be "Difference Makers."

This year's NGFA convention will help equip us to meet that challenge, delivering the information, knowledge and industry networking opportunities to make that possible.

I also want to thank the many of you who work tirelessly serving in leadership positions on the NGFA Board of Directors, as committee chairs and committee members, as elected leaders or executive staff members of State and Regional Grain and Feed Associations, and in countless other capacities. I also want to thank our staff for

its dedicated service in proactively addressing the myriad issues that this great association is called upon to tackle for the benefit of the industry.

To succeed requires that we achieve pro-growth policies, as well as a regulatory environment that does not overly shackle business efficiency. Achieving these twin objectives will demand an even greater commitment from NGFA "Difference Makers" to become more actively and directly involved in our nation's political process – another theme that will permeate this convention.

I encourage you to take advantage of all this convention has to offer. A good start is to attend and participate in the many open committee meetings to learn first-hand – and to provide your input – on the major issues that will affect our businesses in the year ahead. You'll find committee meetings scheduled on Sunday afternoon, as well as Monday and Tuesday mornings. The major agenda topics for each committee are listed in the program so you can pick those that have the most interest and relevance to you and your business. As an industry-driven association, the committee structure is the heart-and-soul of NGFA.

I also encourage you to attend the major Transportation Open Forum on Sunday afternoon, as well as the outstanding general sessions on Monday and Tuesday mornings. Interacting with our convention speakers, exchanging ideas with your industry colleagues and enjoying this vibrant community with your friends and family are integral parts of the NGFA convention experience.

Finally, let me thank you for the privilege and honor of having served as NGFA chairman the past two years. I appreciate all the support you have given me. Yes, we have big challenges ahead that will require even more active involvement from each of us as "Difference Makers." But we're also part of a great team!

I'm excited to see what the future holds as our industry continues to invest time, talent and resources in using this great Association to make a difference in a changing world.

A Special Thank You Our Sponsors

Platinum



Gold



Silver

American Railcar Leasing
APEX LLC
Arizona Grain Inc.
Attebury Grain LLC
Beachner Grain Inc.
Canadian Pacific
Central States Enterprises LLC
CIT Rail
Commerce Bank
Crowe Horwath
Faegre Baker Daniels
Farm Credit Services of America
GATX Rail
GlobalView
GROWMARK/MIDCO COMMODITIES, INC.
J.W. Nutt Co.

Kokomo Grain
Laughlin Cartrell
Mitsui Rail Capital LLC
Monsanto Co.
National Steel Car
Northwest Grain Growers
Perdue AgriBusiness LLC
Riceland Foods Inc.
The Greenbrier Companies
Trinity Rail
Union Pacific Railroad
Union Tank Car Co.
US Bank
US Commodities
Vertex Railcar
VTG Rail
Western Milling LLC
Wheeler Brothers Grain Company LLC

A Special Thank You Our Sponsors

Convention program booklet printing sponsored by:



Wifi network sponsored by:



Wifi network: **HOTELDEL-MEETING**

Wifi password: **bankofthewest** (case sensitive)

How to connect:

1. Turn on your Wireless LAN (Wi-Fi) enabled computer
2. Connect the computer to the meeting room network by searching and selecting the wireless network (Name/SSID) "HOTELDEL-MEETING", or in the network settings for your WLAN card, set the SSID to "HOTELDEL-MEETING".
3. Start your Internet browser, and go to a public web site.
4. Enter "bankofthewest" and press "Continue"
5. You are connected to the Internet.

Convention Program

The Difference Makers

Saturday, March 12, 2016

6:30 – 8 pm
Garden Patio

NGFA Chairman's Reception (*Invitation only*)
Sponsor: Nidera US LLC

Sunday, March 13, 2016

8 am – 6 pm
Crystal/Continental Room

Registration Open
Sponsored by: MetLife Food & Agribusiness Finance
Refreshments sponsored by: Vertex Railcar

8 - 9:15 am
Hanover Room

National Grain and Feed Foundation Trustees (*Closed*)

9:30 - 11:30 am
Windsor Complex

Executive Committee (*Closed*)

10 am – 6 pm
Crystal/Continental Room

Ag Village Exhibits

11:30 am – 1 pm
Garden Room

Sheerwater Restaurant

Luncheons (*Invitation only*)
– NGFA Past Chairmen/Presidents
Sponsors: Farm Credit Services of America, Louis Dreyfus Commodities
– NGFA Past Chairmen's/Presidents' Spouses

1 – 3 pm
Carousel Room

Committee Meetings
– Country Elevator

- Update on NGFA Truck Trade Rules
- Education and Training for FDA's Implementation of FSMA
- Update on CFTC Futures Market Customer Protection Rules
- New U.S. Department of Transportation Rule on E-logs
- Ideas for 2016 Country Elevator Conference

Palms/Sunset Room

– Trade Rules

- Secondary Rail Freight Trading Rules Update
- Opening of Mid-Mississippi
- Trade Rules and Arbitration Seminar: Plans for a Web-based Version
- New Issues and Rules for Further Review in 2016

Pointe Room

– Rail Shipper/Receiver (*Closed*)

3:15 – 5:15 pm
Spreckels C&D

Committee Meetings
– International Trade/Agricultural Policy

- Update on Agriculture in Canada
- Discussion on Trade Deals
- The Next Farm Bill
- Mycotoxin Testing as it Relates to Crop Insurance
- Natural, Organic, Non-GMO, GMO, Sustainability- What Does It All Mean?
- Statements on Agriculture by Presidential Candidates

Sunday, March 13, 2016 (Cont.)

- Bayside/Strand Room – Joint Meeting: Biofuels and Co-Products/Feed Legislative and Regulatory Affairs/Feed Manufacturing and Technology
- Status of FDA's Implementation of Food Safety Modernization Act
 - NGFA's FSMA Education and Training Activities
 - FDA's Antimicrobial Resistance Policies – Influence on Medicated Feed
 - USDA's Role in Marketing DDGs
- Wilder E&F – Biotechnology
- Prospects for Enacting Federal Biotech Labeling Legislation Preempting State/Local Laws
 - NGFA's Future Role and Participation in U.S. Biotech Crops Alliance
 - NGFA's Approach to APHIS's Future Biotech Regulatory Framework
 - Utilizing Trade Accommodation with Willing International Partners
- Seabreeze Room – Risk Management/Finance and Administration
- Insurance for Futures Customers – A Viable Concept?
 - High Frequency Trading – Issues and Impacts
 - Guest Presenter – Tim Andriesen, CME Group
 - CFTC's Automated Trade Proposal – What Should We Request?
- 3:30 – 5:30 pm**
Ballroom
- Transportation Open Forum**
-Hosted by Rail Shipper/Receiver Committee and Waterborne Commerce Committee
-Moderator: Kevin Thompson, Chairman, NGFA Rail Shipper/Receiver Committee; Assistant Vice President, Transportation Lead, Cargill Inc., Minneapolis, Minn.
- “Modernizing Freight Rail Regulation – Our Recommendations and How to Achieve Them”**
Thomas Menzies, Deputy Program Director
Transportation Research Board, National Academies of Science
Washington, D.C.
- “Update on Implementation of STB Reauthorization Law”**
Tom Wilcox, NGFA Transportation Counsel
Partner, GKG Law PC, Washington, D.C.
- “2016 Outlook: Freight Markets on the Precipice”**
Noël Perry, Economist and Senior Consultant
FTR Transportation Intelligence, Bloomington, Ind.
- “Waterways Legislation – 2015 Accomplishments and 2016 Forecast”** Bobby Frederick, NGFA Director of Legislative Affairs
Washington, D.C.
- 5:30 – 6 pm**
Vista Walk
- New Member/First-Time-Attendee Reception** (*Invitation only*)
Sponsor: Harris-Crane, Inc.
- 6 – 7:30 pm**
Sundeck
- CoBank Welcome Reception**
Sponsor: CoBank

Monday, March 14, 2016

7 am – 12:30 pm
Crystal/Continental

Registration

Sponsor: MetLife Food & Agribusiness Finance

7 am – Noon
Crystal/Continental

Ag Village Exhibits

7 – 8:15 am
Garden Patio

Networking Coffee Break

Sponsor: Monsanto Co.

7:30 – 8:30 am
Garden Room

Committee Meeting

– Rail Arbitration Rules Committee

- NGFA Rail Arbitration – Overview and General Report
- Review of Commodities Subject to Rail Arbitration by STCC
- Comprehensive Updating and Clarification of Terms

7:30 – 8:15 am
Coronet Room

Committee Meeting

– Waterborne Commerce

- Waterways Funding: Making it Rain in FY 2017
- WRRDA 2016
- Assessing the Viability of Public/Private Partnerships

8:30 – 11:15 am
Ballroom

General Session Convenes

Grand Opening Breakfast and General Session

Sponsor: ABN AMRO; ABN AMRO Clearing; ADM; CGB Enterprises; Rabobank

Moderator: Gary Beachner, NGFA Chairman; President and Chief Executive Officer, Beachner Grain Inc., Parsons, Kan.

Recognition of NGFA Past Chairmen/Presidents

Recognition of 2015-16 CAPs and Introduction of 2016-17 CAPs

“What Washington Giveth, Washington Can Taketh Away”

Comm. J. Christopher Giancarlo, Commodity Futures Trading Commission Washington, D.C.

Recognition of Retiring NGFA Directors; Industry Service Awards

“The World in Crisis — What to Expect in 2016 and Beyond”

Ivo Daalder, President, The Chicago Council on Global Affairs Chicago, Ill.

“How to Mitigate Both Facility and Cyber Threats”

Michael Zweiback, Partner and Co Leader, Cybersecurity and Data Protection Group, Arent Fox LLP, Los Angeles, Calif.

11:15 am

General Session Recesses

10 am – Noon
Crown Room

Spouse/Guest Activity and Breakfast

Operation Give Back Care Pack

11:30 am – 6 pm
Meet in Lobby

NGFF Classic Golf Tournament

(Advance registration required; Bus departs 11:30 am for Steele Canyon Golf Club)

Monday, March 14, 2016 (cont.)

12:30 – 4:30 pm

Meet in Lobby

Afternoon Tour: La Jolla Nature & Nurture Tour

(Advance registration required; bus departs at 12:30 pm)

6:30 – 7:30 pm

Windsor Lawn

Bunge North America Inc. Evening Reception

(all convention registrants invited)

Sponsor: Bunge North America Inc.

Tuesday, March 15, 2016

7 am – Noon

Crystal/Continental

Registration

Sponsor: MetLife Food & Agribusiness Finance

7 am – Noon

Crystal/Continental

Ag Village Exhibits

7:30 – 9 am

Crown Room

Idea Exchange Continental Breakfast

Sponsor: Cargill Inc.

7 – 8:45 am

Tudor Room

Committee Meetings

– Arbitration Appeals Panel

Bayside/Strand

– Joint NGFA/NAEGA Grain Grades and Weights Committee

- Joint NGFA/NAEGA Comments on GIPSA Proposed Rule Implementing Changes to U.S. Grain Standards Act
- Industry/FGIS Workshops to Address Current Practices and Opportunities for Improvement in the Official Grain Inspection Process
- NAEGA Grades and Inspections Committee Work Plan for 2016
 - Phytosanitary issues, including electronic certificates
 - SOLAS compliance for containers
 - U.S./Canada trade concerns

9 am – Noon

Ballroom

General Session Convenes

Moderator: Gary Beachner, NGFA Chairman; President and Chief Executive Officer, Beachner Grain Inc., Parsons, Kan.

Annual Business Meeting

Industry Recognitions - Committee Chair and Arbitrator Awards

Moderator: John Heck, Senior Vice President, The Scoular Co., Omaha, Neb.

"Getting Real: Navigating Today's World"

Carl Casale, President and Chief Executive Officer, CHS Inc.

Inver Grove Heights, Minn.

Membership Awards

Garden Patio

Coffee Break

Sponsored by: GROWMARK/MIDCO COMMODITIES, INC.; Arizona Grain Inc.; Attebury Grain LLC

Tuesday, March 15, 2016 (cont'd)

Moderator: Eric Wilkey, President, Arizona Grain Inc., Casa Grande, Ariz.

“The Difference Makers” Gary Beachner, NGFA Chairman; President and Chief Executive Officer, Beachner Grain Inc., Parsons, Kan.

“It’s Not That 70s Show: Zero Rates, No Inflation, and Other Extremes” Stephen W. Gallagher, Managing Director/Head of Research, Société Générale, New York, N.Y.

Noon

General Session Adjourns

Noon – 12:45 pm
Coronet Room

Board of Directors Lunch *(Closed)*
Sponsor: CME Group

Noon – 12:45 pm
Windsor Complex

Committee Apprentice Luncheon *(Invitation only)*

12:45 – 4:45 pm
Meet in Lobby

Afternoon Tour: Sailing on the Aolani
(Advance registration required; bus departs 12:45 pm)

12:45 – 4:45 pm
Meet in Lobby

Afternoon Tour: Sailing on the Adventuress
(Advance registration required; bus departs 12:45 pm)

12:45 – 4:45 pm
Meet in Lobby

Afternoon Tour: Downtown Brewery
(Advance registration required; bus departs 12:45 pm)

12:45 – 4:45 pm
Meet in Lobby

Afternoon Tour: USS Midway Museum
(Advance registration required; bus departs 12:45 pm)

1 – 3:30 pm
Crown Room

Board of Directors Meeting *(closed)*

3:30 – 4 pm
Windsor Complex

Executive Committee Meeting *(closed)*

6:30 – 10 pm
North Beach

Gala Banquet Reception, Dinner and IFG Export Grain Terminal Fireworks Show

Gala Banquet Dinner and IFG Export Grain Terminal Fireworks Show

Sponsors

Platinum: IFG Export Grain Terminal; CGB Enterprises

Gold: Dupont Pioneer; CHS; Lansing Trade Group; Harris-Crane, Inc.; Louis Dreyfus Commodities; MetLife Investments

Silver: US Bank; APEX LLC; Attebury Grain LLC; Beachner Grain; Farm Credit Services of America; Laughlin Cartrell; Riceland Foods Inc.; Union Pacific Railroad; Western Milling LLC



Ag Village Exhibitors

Crystal/Continental Room

AgriCharts (Chicago, IL)

- Matt Giarelli

DTN/The Progressive Farmer (Burnsville, MN)

- Beth Johnson

Global View Software (Chicago, IL)

- Charlie Trauger

Hulcher Professional Services (Denton, TX)

- Cleman Decker

Inland Tarp and Liner (Moses Lake, WA)

- Matt Purcell

One Source Risk Management & Funding Inc. (Sugar Land, TX)

- John Flahaut

Sukup Manufacturing Company (Sheffield, IA)

- Brent Hansen

Swiss Re Corporate Solutions (Chicago, IL)

- Thomas Neher

The GSI Group (Assumption, IL)

- Tobin Pearson

Vertical Software Inc. (Bartonville, IL)

- Patrick Gilroy

Special Welcome

The following new member companies have representatives attending the convention.

These individuals are wearing white ribbons on their name badges; please say "hello" and make them feel welcome.

Baltic Control North America Inc.

- Osvaldo Valdes

Family Farms Group

- Paul Fox

Form A Feed

- Jarvis Haugeberg

FS Grain

- Dan Mehochko

Ice Miller LLP

- Beth Bechdol

Inland Tarp & Liner

- Matt Purcell

Save the Date



NGFA's 121st Annual Convention

March 19-21, 2017
New Orleans, La.

Board of Directors 2015-2016

Travis	Antonsen	South Dakota Wheat Growers Assn.	Hugh	Parker	Ingredion Inc.
Keith	Bailey	AgVentures NW LLC	Ryan	Pellett	J.D. Heiskell & Co.
Augusto	Bassanini	United Grain Corp.	Sonny	Perdue	AGrowStar
David	Baudler	Cargill Inc.	Barb	Quandt	West Central Cooperative
Gary	Beachner	Beachner Grain Inc.	Hal	Reed	The Andersons Inc.
Beth	Bechdol	Agribusiness Council of Ind. / Indiana Grain and Feed Assn.	Mark	Reisinger	Dupont Pioneer
Greg	Beck	CGB Enterprises Inc.	John	Ripple	Morrow County Grain Growers Inc.
Chris	Boerm	Archer Daniels Midland Company	Kris	Roberts	Tate and Lyle Ingredients Americas Inc.
Robert	Bond	FGDI LLC, a division of AGREX Inc.	Carl	Schwinke	Siemer Milling Co.
Chris	Breedlove	Willacy Co-op	Margerie	Sedam	Pacific Northwest Grain & Feed Association
Tom	Bressner	Wisconsin Agri-Business Assn.	Benjamin	Smith	Attebury Grain LLC
JoAnn	Brouillette	Demeter LP	Bruce	Sutherland	Michigan Agricultural Commodities
Steve	Campbell	Louis Dreyfus Commodities	Will	Waters	Harris-Crane Inc.
Sharon	Clark	Perdue AgriBusiness LLC	Kevin	Whitehall	Central Washington Grain Growers Inc.
Jerry	Cope	Dakota Mill and Grain Inc.	Eric	Wilkey	Arizona Grain Inc.
Thomas	Coyle	Nidera US LLC	Don	Woodburn	Ag Processing Inc.
CC	Craig	Farmers Grain Terminal Inc.			
Mitch	Dawson	MFA Inc.			
Dan	DeRouchey	Berthold Farmers Elevator LLC			
Scott	Docherty	Topflight Grain Cooperative			
Scott	Dubbelde	Farmers Cooperative Elevator Co.			
Geoff	Finch	Wenger's Feed Mill Inc.			
John	Fletcher	Central Missouri AGRIService LLC			
Roger	Fray	West Central Cooperative			
Gary	Gantz	D. E. Bondurant Grain Co. Inc.			
Matt	Gibson	Bunge North America Inc.			
Scott	Gower	Riceland Foods Inc.			
Jarvis	Haugeberg	Form A Feed			
John	Heck	The Scoular Company			
David	Hoogmoed	Purina Animal Nutrition LLC			
Kyle	Jeworski	Viterra			
Jerald	Kemmerer	Pride Ag Resources			
Diana	Klemme	Grain Service Corp.			
Robert	Knief	Bartlett Grain Co., L.P.			
Greg	Konsor	Gavilon Grain LLC			
Bill	Krueger	Lansing Trade Group, LLC			
Todd	Lafferty	Wheeler Brothers Grain Co.			
Dan	Mack	CHS			
Michael	Meyers	APEX			
Jim	Moore	Southern States Cooperative Inc.			
Chad	Nagel	Nagel Farm Services Inc.			
Robert	Nawrot	Central States Enterprises Inc.			

Thank You

NGFA thanks the following Board members who have completed their terms of service over the past year:

- James Dell, Cooperative Producers Inc., Hastings, NE
- Scott Dubbelde, Farmers Cooperative Elevator Co., Hanley Falls, MN
- Greg Konsor, Gavilon Grain, Omaha, NE
- Bill Krueger, Lansing Trade Group LLC, Overland Park, KS
- Robert Nawrot, Central States Enterprises, Heathrow, FL
- Michael Orgas, Green Plains Renewable Energy Inc., Omaha, NE
- Hugh Parker, Ingredion Inc., Westchester, IL
- Hal Reed, The Andersons, Maumee, OH
- Mark Reisinger, Dupont Pioneer, Johnston, IA
- John Ripple, Morrow County Grain Growers Inc., Lexington, OR
- John Skelley, West Plains LLC, Kansas City, MO
- Kevin Whitehall, Central Washington Grain Growers, Marlin, WA

Arbitrators

Thank You for Your Service

Arbitrators are shown with companies where they worked at the time of the arbitration case.

Travis Antonsen

South Dakota Wheat Growers Assn., Aberdeen, SD

Keith Bailey

AgVentures NW LLC, Odessa, WA

Heath Barnes

Whitgro Inc., St. John, WA

Kim Behr

Trupointe Cooperative Inc., Botkins, OH

John Brammeier

Co-Alliance LLP, Avon, IN

Raymond Defenbaugh

Big River Resources LLC, West Burlington, IA

James Dell

Interstate Mills LLC, Owatonna, MN

Steve Dennis

Evergreen FS Inc., Bloomington, IL

John Fletcher

Central Missouri AGRIService LLC, Marshall, MO

Robert Geers

Michigan Agricultural Commodities, Lansing, MI

Matt Gibson

Lifeline Foods LLC, St. Joseph, MO

Lori Goetzinger

West Central Cooperative, Ralston, IA

Jennifer Hanson

PFFJ Inc. – Farm Division, Corcoran, CA

Craig Haugaard

North Central Farmers Elevator, Ipswich, SD

Lloyd Heimbecker

Parrish & Heimbecker Ltd., Lethbridge, Alberta, Canada

Mike Irmen

The Andersons Inc., Maumee, OH

Dean Isaacson

Western Consolidated Cooperative, Holloway, MN

Jim Johnson

Crystal Valley Co-op, Hope, MN

Steve Lachey

Larsen Cooperative Co., New London, WI

Scott Lovin

Ag Partners LLC, Albert City, IA

Todd Lafferty

Wheeler Brothers Grain Co., Watonga, OK

Brian Leydens

Starke County Farm Bureau Co-op, Hamlet, IN

Michelle Mapes

Green Plains Renewable Energy Inc., Omaha, NE

Jay Mathews

Midwest Grain LLC, Bloomington, IL

Ryan McKnight

Linear Grain Inc., Carman, Manitoba, Canada

Randolph Mitchell

Perdue Farms Inc., Salisbury, MD

Chris Olinger

Wenger's Feed Mill Inc., Rheems, PA

Lee Paarlberg

Ingredion Inc., Indianapolis, IN

David Reiff

Reiff Grain & Feed Inc., Fairfield, IA

Mike Schon

Pro Cooperative, Pocahontas, IA

Joe Smith

Arizona Grain, Casa Grande, AZ

Ernie Theilen

Garber Co-op Association, Garber, OK

Andrew Wold

Leland Farmers Co., Leland, IL

Committee Chairs

Agroterrorism/Facility Security	Anthony Yount
Arbitration Appeals	Roger Krueger
Biofuels and Co-Products	Matt Gibson
Biotechnology	Anthony Reed
Country Elevator	Randall Broady
Feed Legislative/Regulatory Affairs	Jarvis Haugeberg
Feed Manufacturing/Technology	Matt Frederking
Finance & Administration	Larry Callahan
Grain Grades & Weights	Nick Friant
International Trade/Ag Policy	JoAnn Brouillette
Legal Council	Joan Maclin
Marketing, Membership & Communications	Mark Avery
Rail Arbitration Rules	John Miller
Rail Shipper/Receiver	Kevin Thompson
Risk Management	MJ Anderson
Safety, Health & Environmental Quality	Greg Rowe
Trade Rules	Dean O'Harris
Waterborne Commerce	Rick Calhoun

About Committees

Comprised of more than 300 dedicated industry volunteers from all types and sizes of member companies, NGFA committees work proactively for the mutual benefit of the industry. They ensure that diverse issues are addressed effectively by a cross section of members who have expertise and experience in the subject matter.

Foundation

Making a Difference in the Industry

Golf Tournament

Each year, NGFA hosts a golf tournament during convention to support the National Grain and Feed Foundation (NGFF). This year, participants will play at The Steele Canyon Golf Club, a 27-hole championship course personally designed by Gary Player with respect and appreciation for the natural beauty of the terrain.

About NGFF

Established in 1965, the National Grain and Feed Foundation provides support for public education and research projects that benefit the grain, feed and processing industry, enhance its presence to the public, and position it for future growth.

All administrative support and management expertise for the day-to-day operations of the Foundation are donated by the NGFA. That means 100 percent of funds contributed is directed to research and education. Recent Foundation projects have included:

- Conservation Reserve Program research and analysis.
- Regional safety and health seminars.
- Video on safe grain bin entry at elevators and on farms.
- Public education on inland waterway infrastructure
- Support for Council for Agricultural Science and Technology, and Animal Agriculture Alliance.

Donations

Donations to National Grain and Feed Foundation generally qualify as charitable contributions for federal income tax purposes. Donations may be made by individuals, corporations or other foundations with similar goals, and often are made in honor or memory of past industry leaders or colleagues. Contributions should be sent to:

National Grain and Feed Foundation
 1250 Eye St., N.W.
 Suite 1003
 Washington, D.C., 20005

Executive Committee 2015-2016

David Baudler	Cargill Inc.
Gary Beachner	Beachner Grain Inc.
Greg Beck	CGB Enterprises Inc.
Chris Boerm	Archer Daniels Midland Co.
Steve Campbell	Louis Dreyfus Commodities
Thomas Coyle	Nidera US LLC
Geoff Finch	Wenger's Feed Mill Inc.
John Fletcher	Central Missouri AGRIService LLC
Roger Fray	West Central Cooperative
John Heck	The Scoular Co.
Dave Hoogmoed	Purina Animal Nutrition LLC
Diana Klemme	Grain Service Corp.
Todd Lafferty	Wheeler Brothers Grain Co.
Dan Mack	CHS Inc.
Ryan Pellett	J.D. Heiskell & Co.
Hal Reed	The Andersons Inc.
Eric Wilkey	Arizona Grain Inc.
Randy Gordon	National Grain and Feed Association

NGFA Officers



Chairman
Gary Beachner
Beachner Grain Inc.
Parsons, Kan.



First Vice Chairman
John Heck
The Scoular Co.
Omaha, Neb.



Second Vice Chairman
Eric Wilkey
Arizona Grain Inc.
Casa Grande, Ariz.



Immediate Past Chairman
David Hoogmoed
Purina Animal
Nutrition LLC
Shoreview, Minn.

NGFA Staff

- Randall C. Gordon, President
- Todd E. Kemp, Senior Vice President of Marketing and Treasurer
- David A. Fairfield, Senior Vice President of Feed Services
- Charles M. Delacruz, Senior Vice President, General Counsel and Secretary
- Jess McCluer, Vice President of Safety and Regulatory Affairs
- Max Fisher, Director of Economics and Government Relations
- Bobby Frederick, Director of Legislative Affairs and Public Policy
- Sarah Gonzalez, Director of Communications and Digital Media
- Rebecca Grubbs, Director, Meetings and Event Marketing
- Tamela S. Elliott, Senior Manager of Business Operations
- Faith Silvers, Manager, Database/Member Services
- Mary Hitchcock, Manager of Arbitration/Mediation Services
- Chanel Skinner, Executive Administrative Assistant

NGFA Purpose

The NGFA is a broad-based organization representing and providing services for grain, feed and all related commercial interests. Association activities are focused on the growth and economic performance of U.S. agriculture.

Hotel del Coronado

Finding Your Meeting

MEETING ROOMS

Victorian Building

- 1 CROWN
- 2 CORONET
- 3 BALLROOM
- 4 CAROUSEL
- 5 WINDSOR COMPLEX
- 6 WINDSOR
- 7 EMBASSY
- 8 CRYSTAL
- 9 CONTINENTAL
- 10 EXECUTIVE ROOM
- 11 GARDEN ROOM
- 12 HANOVER
- 13 STUART
- 14 TUDOR
- 15 KENT
- 16 YORK

Grande Hall

- 17 UPPER GRANDE HALL
- 18 EMPRESS
- 19 REGENT
- 20 VICEROY
- 21 SPRECKELS COMPLEX
- 22 SPRECKELS SALON A
- 23 SPRECKELS SALON B
- 24 SPRECKELS SALON C
- 25 SPRECKELS SALON D
- 26 WILDER COMPLEX
- 27 WILDER SALON E
- 28 WILDER SALON F
- 29 WILDER SALON G
- 30 WILDER SALON H
- 31 EDISON COMPLEX
- 32 EDISON SALON I
- 33 EDISON SALON J
- 34 EDISON SALON K
- 35 BOARD ROOM

California Cabanas

- 36 TROPICS
- 37 SEA BREEZE
- 38 PALM
- 39 SUNSET
- 40 STRAND
- 41 BAYSIDE
- 42 POINTE
- 43 PACIFICA
- 44 TIDE
- 45 COASTAL
- 46 SURF
- 47 WINDSOR COTTAGE
- 48 WINDSOR LAWN
- 49 VISTA WALK

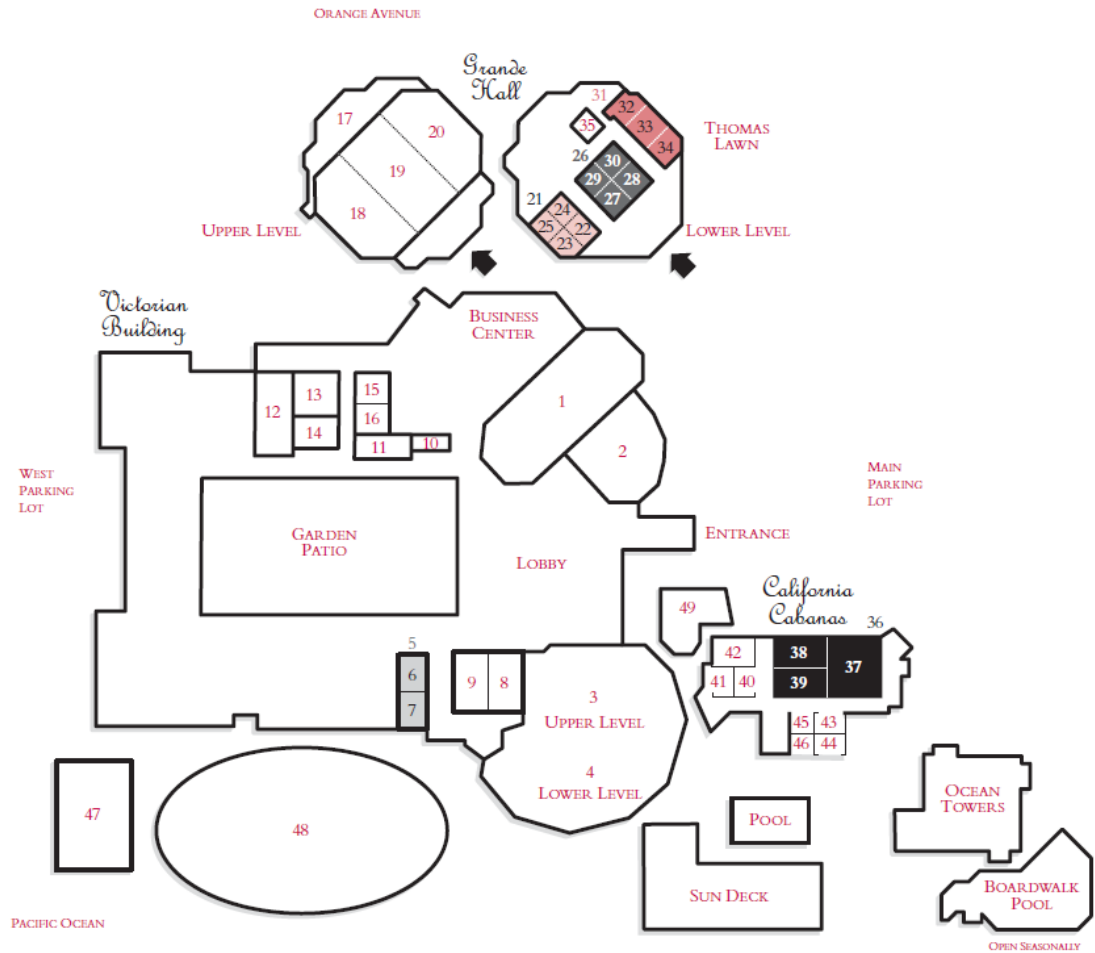

NGFA's 2016 Annual Convention goes mobile. Get it now.

powered by **TripBuilder®**

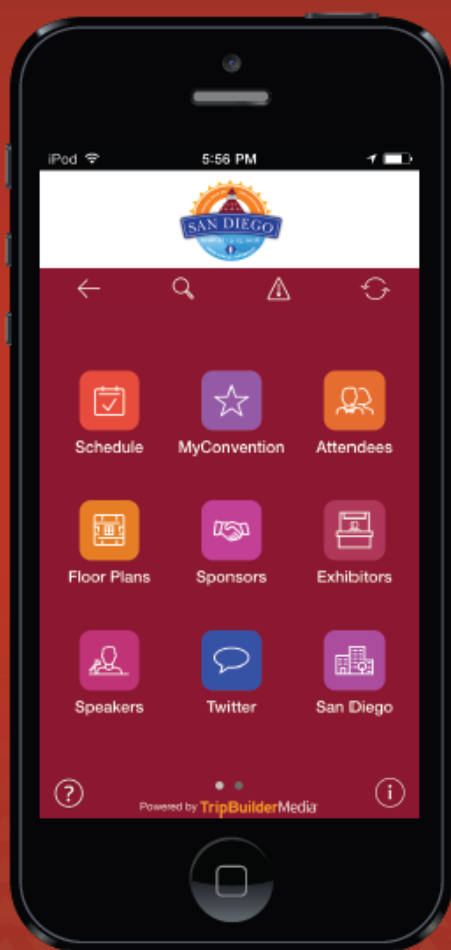

Plug www.tripbuildermedia.com/apps/ngfa2016 into your phone's browser. This link will automatically detect your phone type and take you to the right place to download the app.

Or, just snap this QR Code & download the app now!



Maximize your time at the show with **TripBuilder EventMobile™**. Easily view the Schedule, Exhibitors, Speakers, City Content, Instant Alerts and more! You can even create personalized lists to target what you want to see, hear & do.

Sponsored By:



TripBuilder®
EventMobile™

Apple, iPhone, iPad, iPod and iTunes are registered trademarks of Apple Inc., registered in the U.S. and other countries. BlackBerry is a registered trademark of Research In Motion Ltd., registered in the U.S. and other countries.